



Fin 4 leg table

Assembly Instructions

Note, low table shown but the method is the same for low & high tables

verco.

Chapel Lane, High Wycombe, Buckinghamshire HP12 4BG

t: +44 (0) 1494 448000 w: verco.co.uk

DOC ID: AI_0113

Step 1

assemble the U channel connectors (MUC).
Insert 4 x M8 bolts into the U channel.
Locate the flat plate on top

Bolts **must** be on the inside of the U channel - Do **not** bolt through the rail

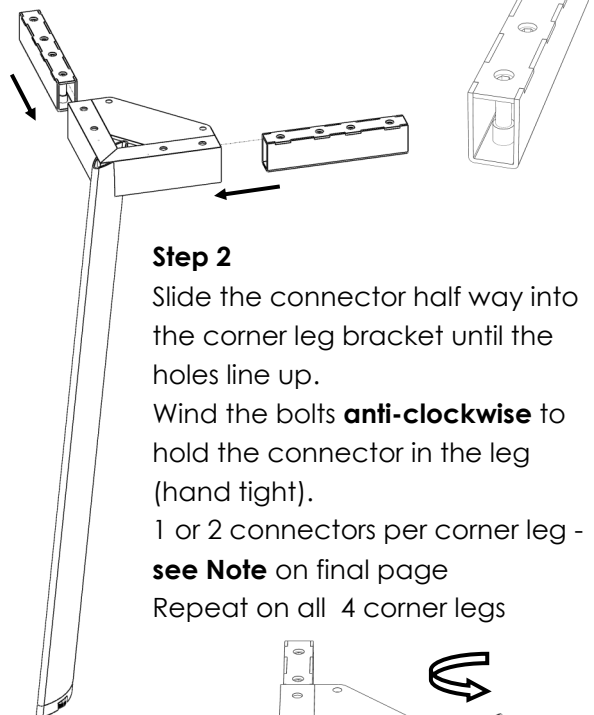

Step 2

Slide the connector half way into the corner leg bracket until the holes line up.
Wind the bolts **anti-clockwise** to hold the connector in the leg (hand tight).
1 or 2 connectors per corner leg - **see Note** on final page
Repeat on all 4 corner legs

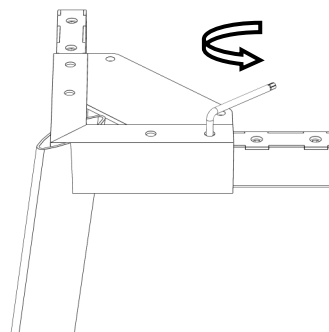

Step 3 - end frame

Join two corner leg assemblies together with 1 of the depth rails.
Secure the rail to the leg bracket by sliding the rail onto the connector & turning all 4 bolts in the connector **anti-clockwise** until tight.
Repeat for the 2nd end frame.

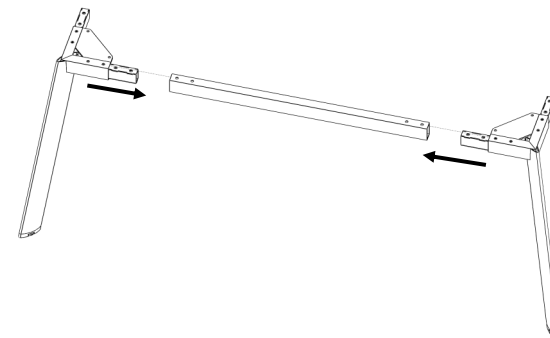

Step 4

Join both end frame (from step 6) together using 2 length rails, sliding them onto the connectors and securing as in previous steps.
Turning all 4 bolts in the connector **anti-clockwise** until tight.

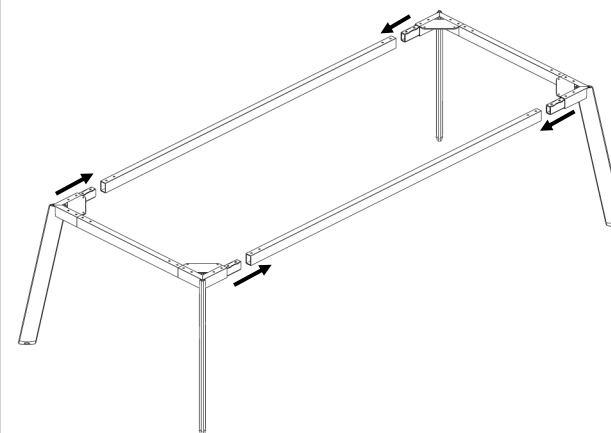

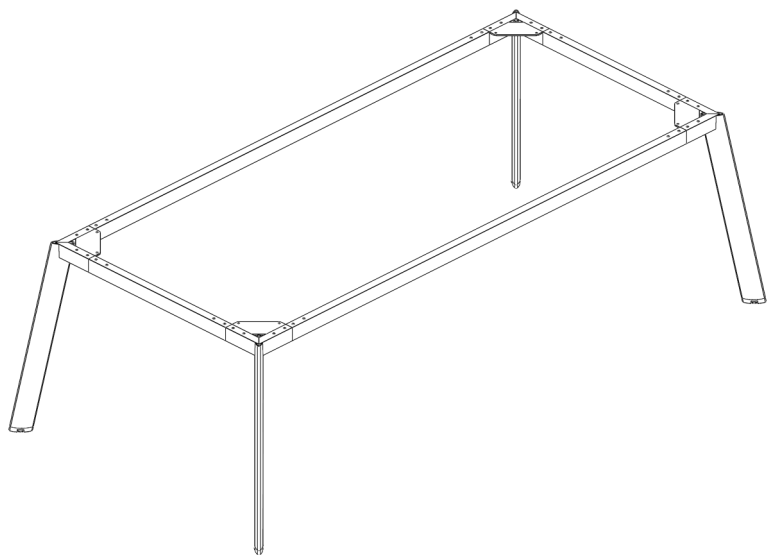

Step 5

Fix the top to the frame using the M6 x 20mm bolts supplied.



Note: 800mm deep high tables

On 800mm deep high tables the end corner legs connect directly to each other without a depth rail in between.

Only one connector is required to join the end legs together.

Length rails are joined as usual - see step 4

